



VARIO-THERM

E2011 Regen Oven

Key features

- Twin oven
 - Twice the capacity in same footprint
- Independent controls for each oven
 - Adds flexibility to kitchen as ovens can be set to different times & temperatures
 - Energy efficient as can turn off one oven when not required
 - Split load capability, cook dense and delicate products at same time
- Digital timer and thermostat per oven
 - Precise time and temperature control
- Triple fans within each oven chamber
 - Delivers even cooking across the chamber
- Fast heat up and recovery times
 - Speeds up the overall cooking operation
- 1/1 gastronorm compatible
 - Accomodates industry standard trays & shelves
 - 61mm between shelves
- 10 shelf capacity per oven
 - Designed for bulk production
 - 10 shelves supplied
 - Landscape loading
- Full stainless steel construction
 - Easy to clean

Accessories

- Additional oven shelf



Measurements *in mm*

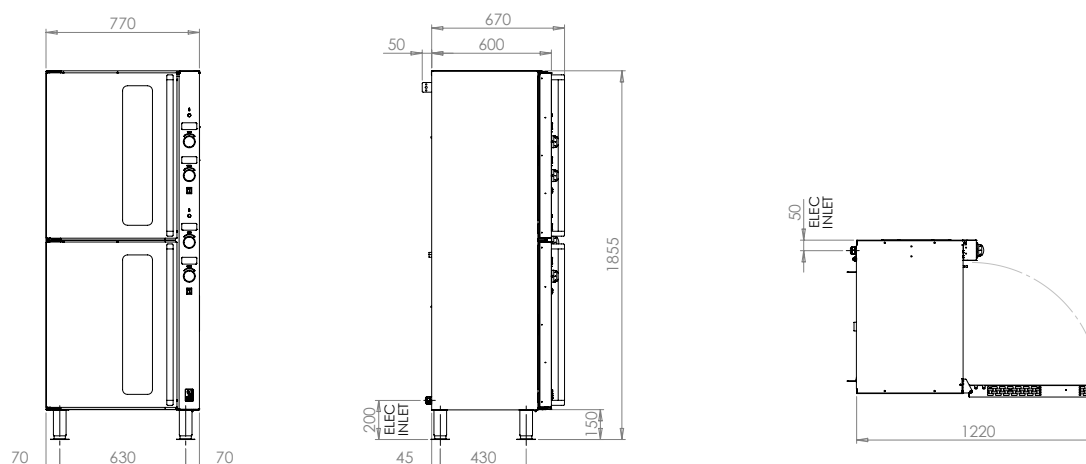

Specification details

| | |
|------------------------------------|------------------------------|
| Electrical rating (kW) | 9.83 |
| Electrical supply voltage | 400V 3N~ |
| Required electrical supply (A) | 16A 3 phase |
| Electrical current split (A) | L1: 14.4, L2: 14.4, L3: 13.9 |
| Element rating (kW) | 9.6 (6 x 1.6) |
| Supplied with mains cable? | No |
| Oven dimensions (w x d x h - mm) | 546 x 370 x 745 |
| Oven shelf (w x d - mm) | 530 x 325 |
| Grid shelf capacity (per oven) | 10 (10 supplied) |
| GN compatibility | 1/1 |
| Weight (kg) | 165 |
| Packed weight (kg) | 180 |
| Packed dimensions (w x d x h - mm) | 800 x 800 x 2100 |
| GTIN number | 5056466907549 |

Installation notes

Adequate ventilation must be provided to supply sufficient fresh air and to allow easy removal of any such products that may present a risk to health. Please consult current legislation for details that relate to specific locations.

Install unit on a level, fireproof surface in a well-lit position. If floor is made of a combustible material, local fire requirements must be checked to ensure compliance. A clearance of 150mm should be observed between appliance and any combustible wall.

Please note this unit must be fixed to the floor or wall.

