



## DOMINATOR **PLUS**

# E3441R Ribbed Griddle

### Key features

- 18mm highly polished ribbed steel griddle plate
  - Provides consistent, even heat
- Temperature range of 80 - 290°C
  - Ability to prepare a wide range of foods
- Thermostatically-controlled
  - Reduces energy consumption, improved operation
- Removable grease container
  - Retains grease for quick and easy cleaning
- Full height surround
  - Protects surrounding areas from splatter
- Laser-etched control icons
  - Permanent, indelible markings

### Accessories

- Fixed stand
- Factory fitted, adjustable castors
- Fixed installation kit



### Similar Models

- E3441 Smooth griddle
- E3481R Half-ribbed griddle
- E3481 Smooth griddle
- G3441 Smooth gas griddle
- G3441R Ribbed gas griddle

## Ribbed Griddle

Measurements *in mm*

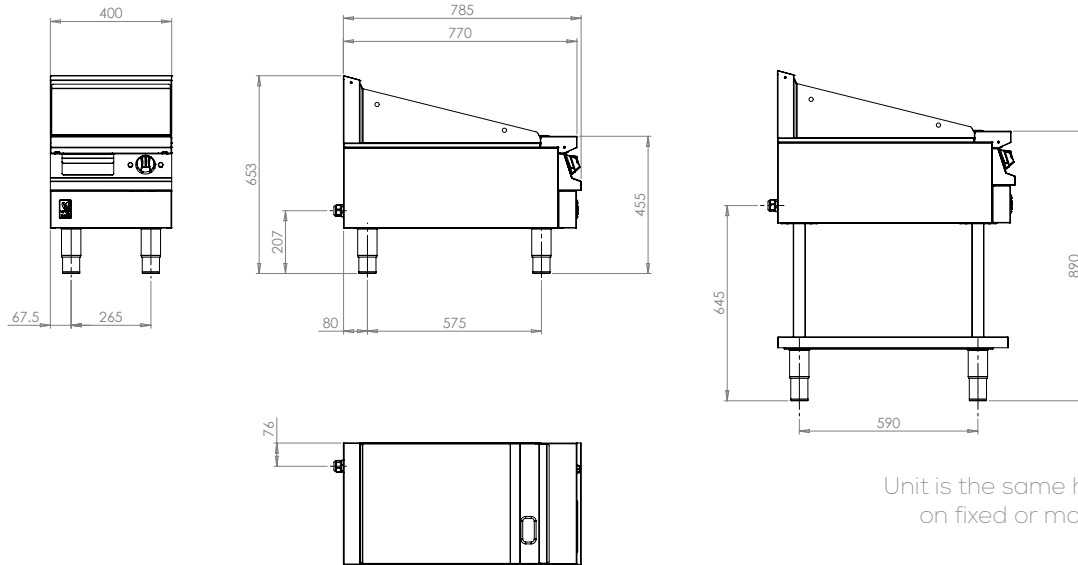

Unit is the same hob height on fixed or mobile stand

## Specification details

Electrical rating (kW)	3.44
Electrical supply voltage	230V~
Required electrical supply 230V~ (A)	16
Electrical current split (A)	L1: 15
Weight (kg)	59
Weight on stand (kg)	77
Packed weight (kg)	67
Packed dimensions (w x d x h - mm)	450 x 1000 x 900
GTIN number	5056466900618

## Installation notes

Adequate ventilation must be provided to supply sufficient fresh air and to allow easy removal of any such products that may present a risk to health. Please consult current legislation for details that relate to specific locations.

Install unit on a level, fireproof surface in a well-lit position. A clearance of 150mm should be observed between appliance and any combustible wall. Please consult the appliance installation manual for further details.

