



## **DOMINATOR***PLUS*

# G3203 Pasta Boiler

### Key features

- Ideal for bulk preparation and individual portions
  - Produce what your customers demand
- Supplied with 3 double handled baskets
  - Ideal for individual portions and regeneration
- Water faucet supplied as standard
  - Couldn't be easier to fill / top up the pan
- Powerful burner system
  - Water reaches boiling point quickly, reducing overall cooking times
- Stainless steel hob with mild steel pan
  - Robust construction to withstand busy demands
- Lid supplied
  - Keeps water covered when not in use
- No electrical supply required
  - Easier install
- Laser-etched control icons
  - Permanent, indelible markings

### Accessories

- Additional basket

### Similar Models

- G3206 pasta boiler
- E3204 electric pasta cooker



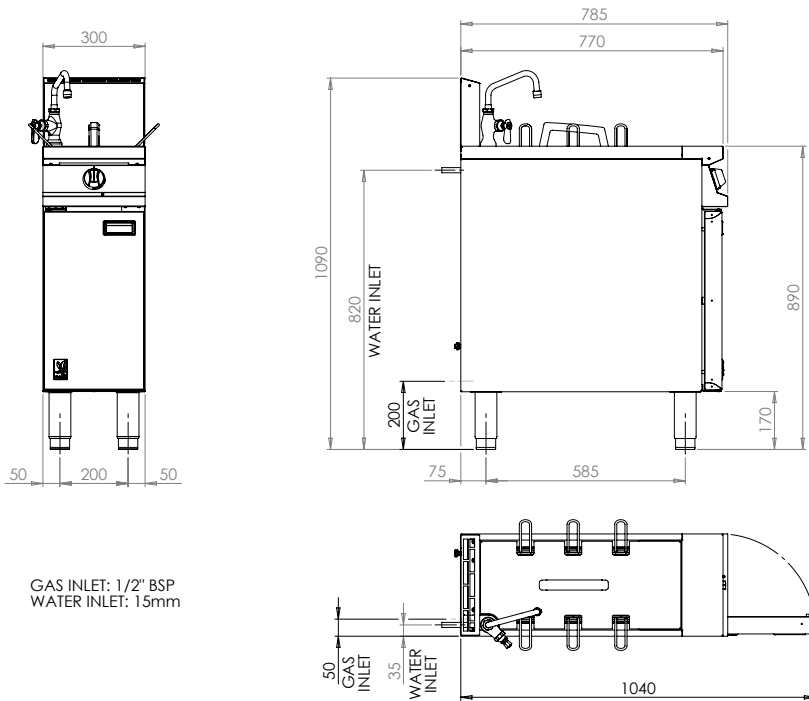

GAS INLET: 1/2" BSP  
WATER INLET: 15mm

Measurements *in mm*

Unit on castors is the same hob height

## Installation notes

Adequate ventilation must be provided to supply sufficient fresh air for combustion and to allow easy removal of any such products that may present a risk to health. Please consult current legislation for details that relate to specific locations.

Install unit on a level, fireproof surface in a well-lit, draught free position. If floor is made of a combustible material, local fire requirements must be checked to ensure compliance.

A clearance of 150mm should be observed between appliance and any combustible wall.

## Specification details

Total rating (natural and propane - kW - Nett)	18.2		
Total rating (natural and propane - btu/hr - gross)	68,300		
Inlet size (natural and propane)	1/2" BSP		
Flow rate - natural (m <sup>3</sup> /hr)	1.91		
Flow rate - propane (kg/hr)	1.41		
Inlet pressure (natural and propane - mbar)	20 / 37		
Operating pressure (natural and propane - mbar)	15 / 37		
Water capacity (litres)	17		
Water supply connection	Ø15 copper		
Water supply pressure	0.5 - 5 bar		
Weight (kg)	65		
Packed weight (kg)	71		
Packed dimensions (w x d x h - mm)	350 x 1000 x 1100		
GTIN numbers			
Nat Gas (feet)	Nat Gas (castors)	LPG (feet)	LPG (castors)
5056466901646	5056466901639	5056466901660	5056466901653

