



DOMINATOR **PLUS**

G3206 Pasta Boiler

Key features

- Ideal for bulk preparation and individual portions
 - Produce what your customers demand
- Supplied with 3 double handled baskets
 - Ideal for individual portions and regeneration
- Water faucet supplied as standard
 - Couldn't be easier to fill / top up the pan
- Powerful burner system
 - Water reaches boiling point quickly, reducing overall cooking times
- Stainless steel hob with mild steel pan
 - Robust construction to withstand busy demands
- Lid supplied
 - Keeps water covered when not in use
- No electrical supply required
 - Easier install
- Fail-safe protection mode
 - **Need more details for this**
- Laser-etched control icons
 - Permanent, indelible markings

Accessories

- Additional basket

Similar Models

- G3203 pasta boiler
- E3204 electric pasta cooker



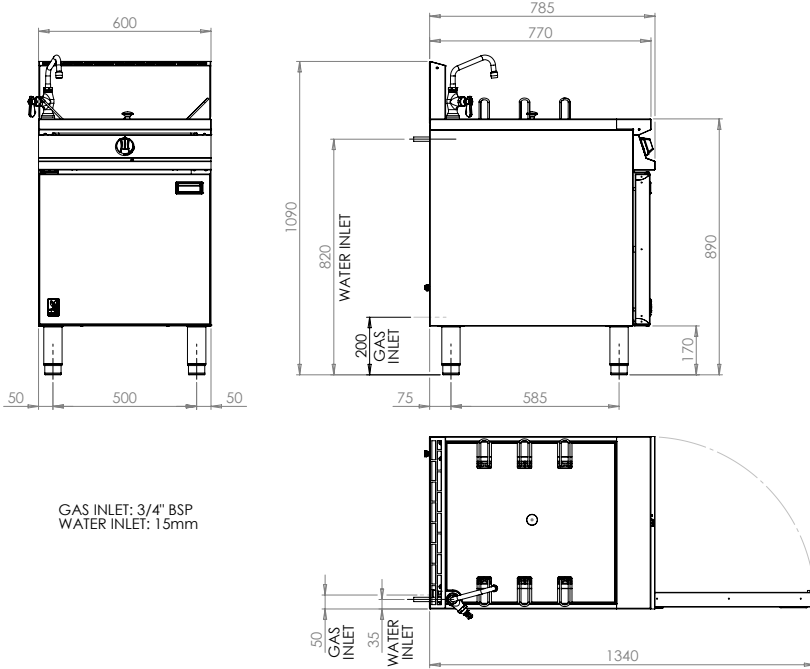

GAS INLET: 3/4" BSP
WATER INLET: 15mm

Measurements *in mm*

Unit on castors is the same
hob height

Installation notes

Adequate ventilation must be provided to supply sufficient fresh air for combustion and to allow easy removal of any such products that may present a risk to health. Please consult current legislation for details that relate to specific locations.

Install unit on a level, fireproof surface in a well-lit, draught free position. If floor is made of a combustible material, local fire requirements must be checked to ensure compliance.

A clearance of 150mm should be observed between appliance and any combustible wall.

Specification *details*

Total rating (natural and propane - kW - Nett)	32.5		
Total rating (natural and propane - btu/hr - gross)	122,000		
Inlet size (natural and propane)	3/4" BSP		
Flow rate - natural (m ³ /hr)	3.44		
Flow rate - propane (kg/hr)	2.41		
Inlet pressure (natural and propane - mbar)	20 / 37		
Operating pressure (natural and propane - mbar)	15 / 37		
Water capacity (litres)	28		
Water supply connection	Ø15 copper		
Water supply pressure	0.5 - 5 bar		
Weight (kg)	79		
Packed weight (kg)	90		
Packed dimensions (w x d x h - mm)	650 x 1000 x 1100		
GTIN numbers			
Nat Gas (feet)	Nat Gas (castors)	LPG (feet)	LPG (castors)
5056466901684	5056466901677	5056466901660	5056466901653

